

Josh Beaver

The Nichols Company

704.373.9797 (Office) • 704.373.9798 (Fax)

josh@thenicholscompany.com

www.thenicholscompany.com

600 Queens Rd, Charlotte, NC 28207

Available

Retail, Office
or Medical
For Lease



Dilworth Crossing

2230 Park Road | Charlotte, NC 28203

LOCATION

This proposed multi-tenant two-level retail building is located along Park Road in the historic Dilworth neighborhood, less than 2.5 miles from uptown Charlotte. It's also very convenient to a variety of restaurants, businesses and East Blvd & South Blvd.

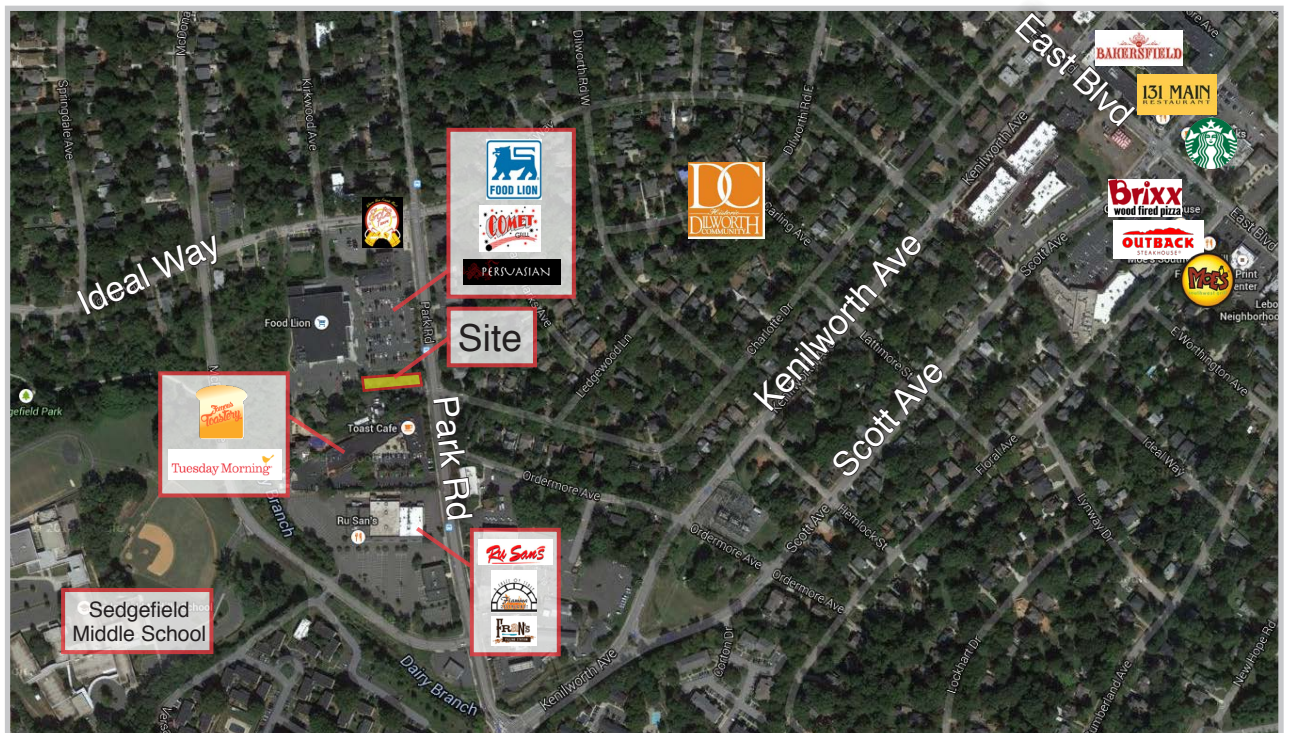
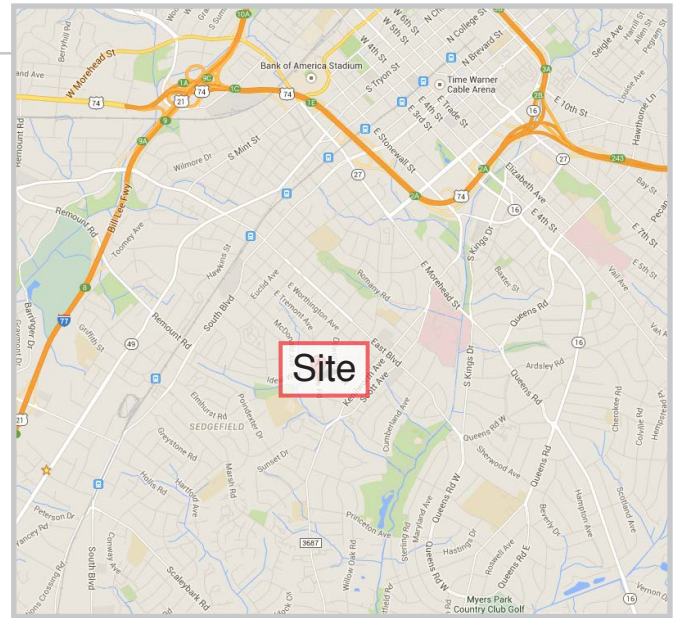

SITE ATTRIBUTES

- 13,468 SF Retail Space in Food Lion Anchored Shopping Center
- +/- 2,514 SF Rooftop Terrace
- 0.3519 Acres
- B-1 Zoning
- 12110127 Parcel ID
- 6,100 VPD on Park Road
- FULLY LEASED

First Floor - 8,023 SF

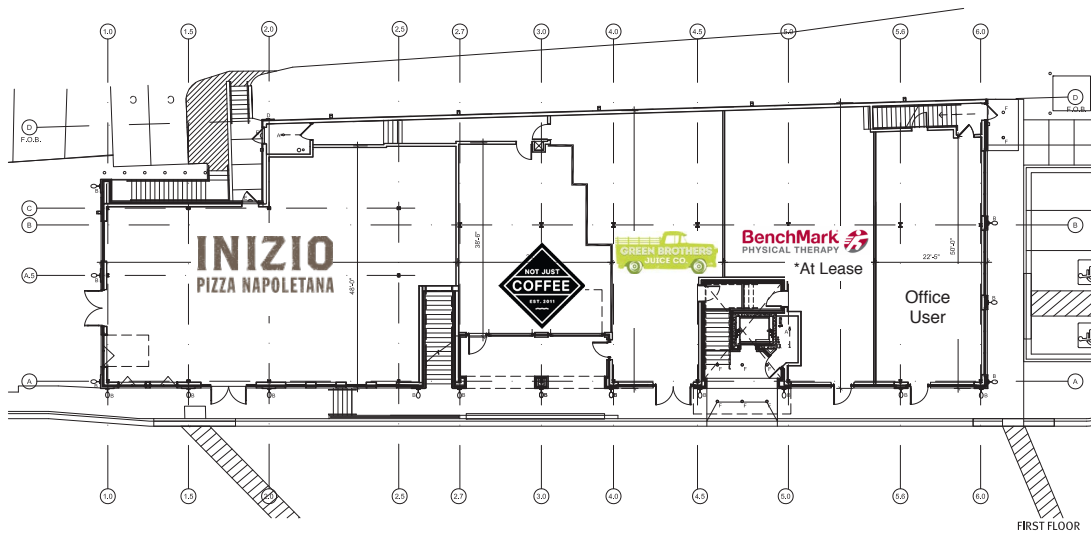

Second Floor - 5,445 SF

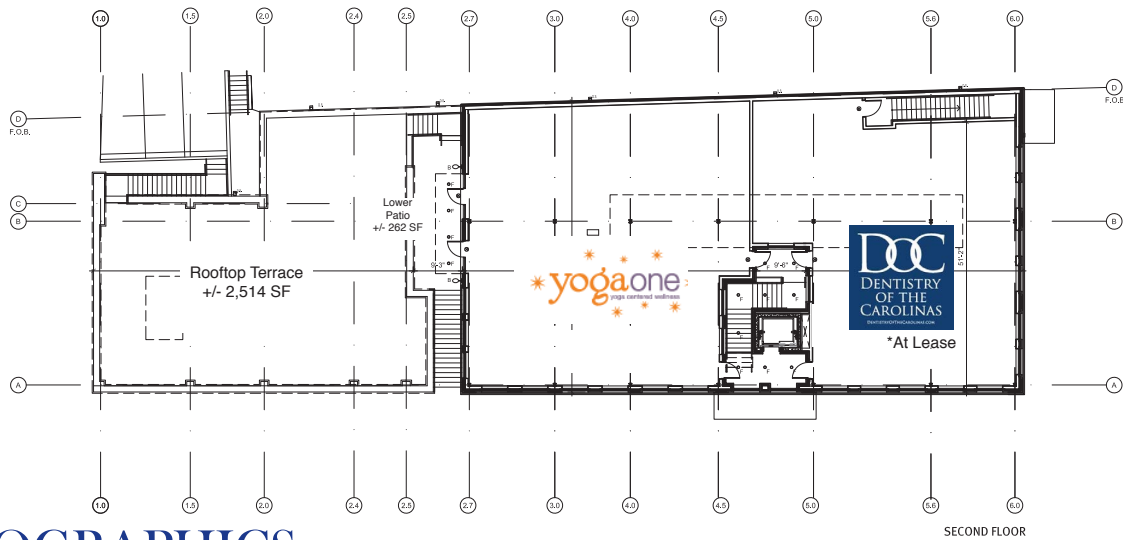

DEMOGRAPHICS

	1 Mile	3 Miles	5 Miles
Population	12,058	88,967	218,376
Daytime Population	6,225	40,825	93,968
Avg HH Income	\$104,517	\$85,119	\$72,389





SITE PLAN

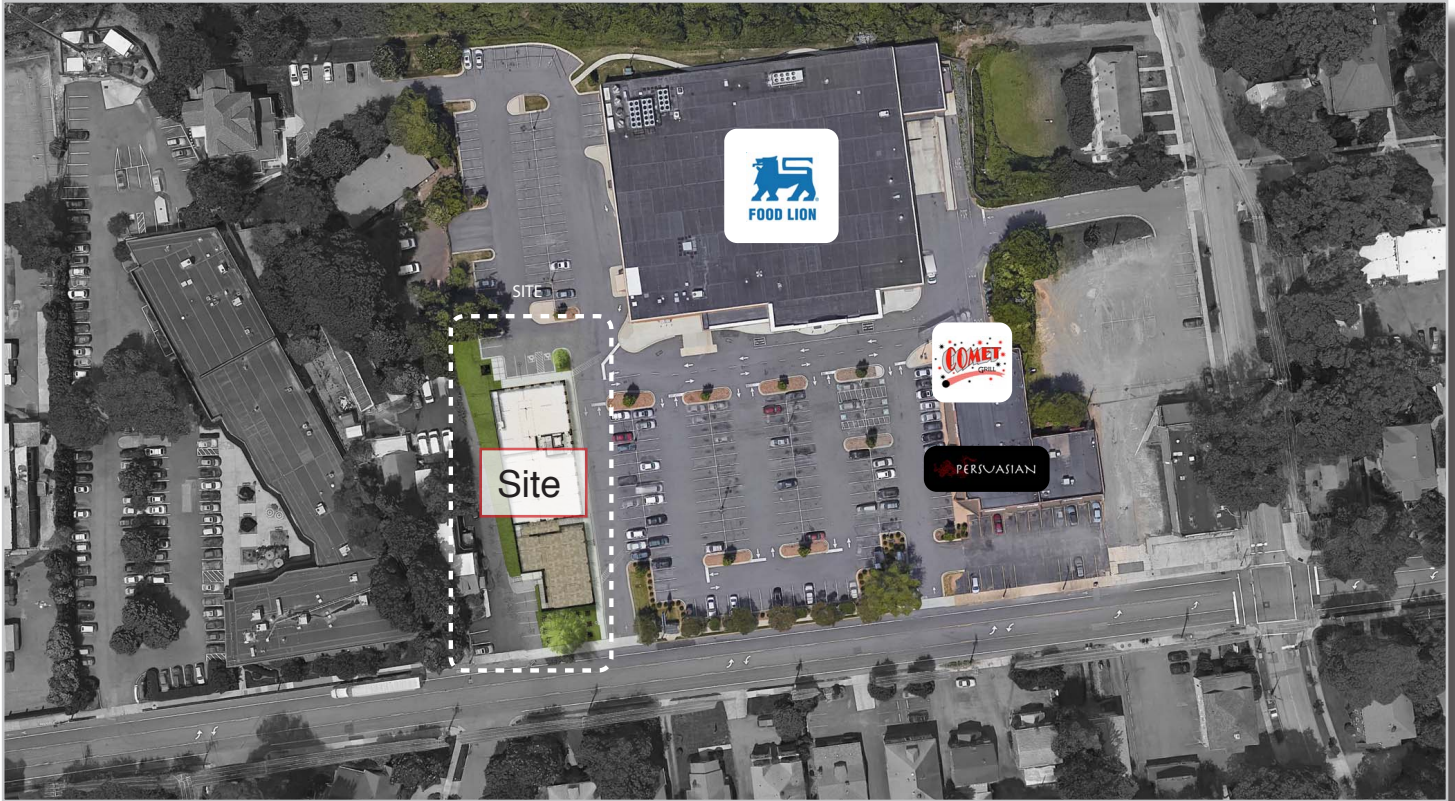

For more information please contact:
Josh Beaver
Josh@thenicholscompany.com
704.373.9797

This information has been obtained from sources believed to be reliable. While we do not doubt its accuracy, we have not verified it and make no guarantee, warranty or representation to independently confirm its accuracy and completeness.

