

Rusty Gibbs

The Nichols Company

704.373.9797 (Office) • 704.373.9798 (Fax)

rusty@thenicholscompany.com

www.thenicholscompany.com

600 Queens Rd, Charlotte, NC 28207

Available
Land for Sale



Old Bethel School

2240 NC Hwy 24-27 E | Midland, NC 28107

Old Bethel School

ABOUT



The old Bethel Elementary School site consists of approximately 10.5 Acres, with 900 ft. of road frontage along Highway 24/27. The site is comprised of 5 buildings (approximately 60,000 sqft) built at various times between 1928 and 1958. In addition the property has 3 ball fields. Great opportunity for adaptive re-use project, or redevelopment, of a well known and important piece of property in Midland, NC.

Located on Highway 24/27 near the intersection with Bethel Church Road in the Town of Midland. The lower end of the property also abuts JM Sossamon Road near the new Bethel Elementary School.

SITE ATTRIBUTES

- +/- 10.5 Acres
- Approx. 900 ft. of frontage on Highway 24/27
- Zoning: Civic (Note: Midland supports re-zoning)
- Parcel ID: 55441839940000
- Utilities Present: Electricity, Water, Phone, Cable
- Price: \$399,000

CONCEPTUAL REDEVELOPMENT RENDERING

2240 Hwy 24/27 East

Bethel Church Rd.

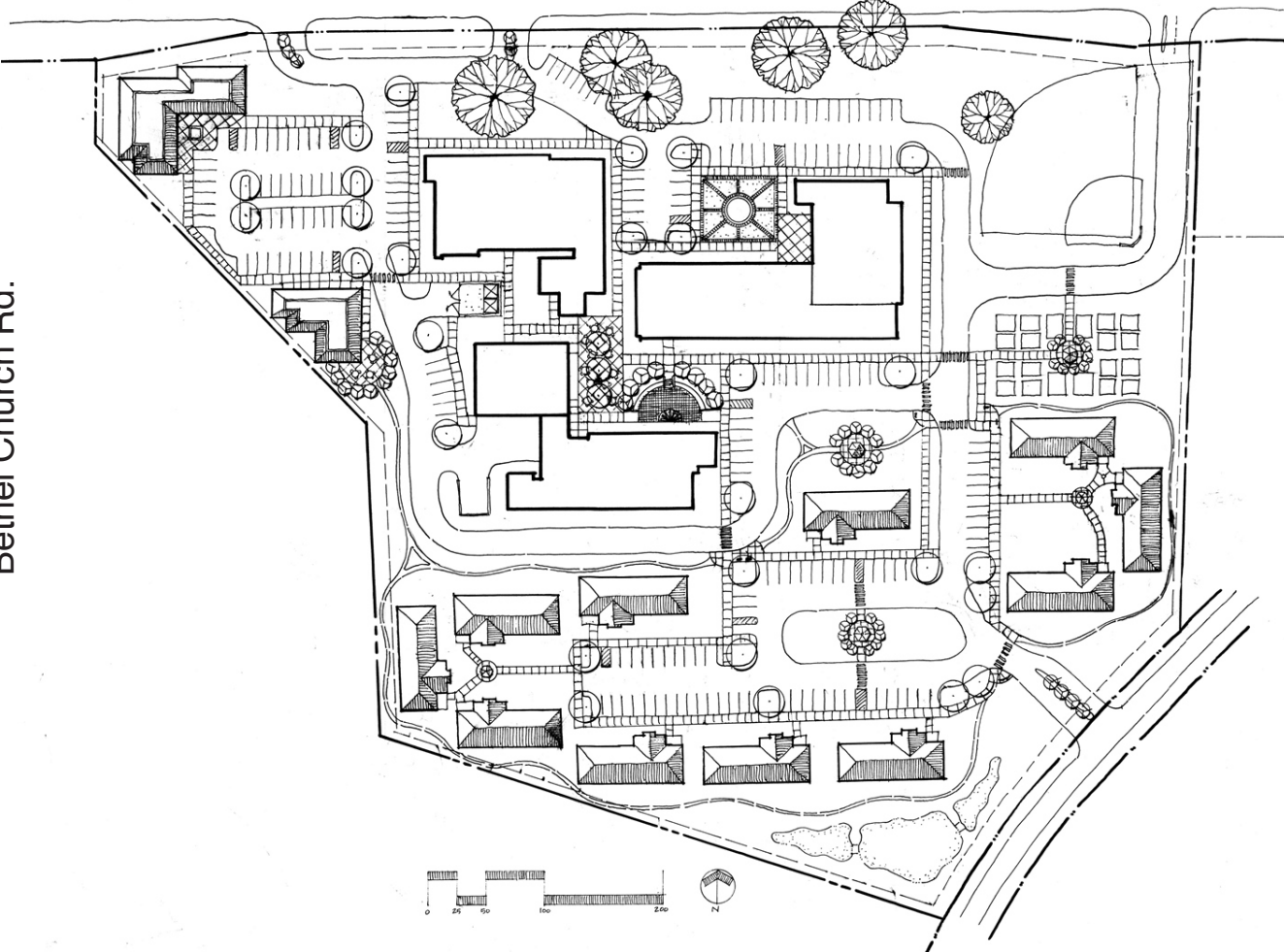

SITE PHOTOS



For more information please contact:
Rusty Gibbs
Rusty@TheNicholsCompany.com
704.373.9797

This information has been obtained from sources believed to be reliable. While we do not doubt its accuracy, we have not verified it and make no guarantee, warranty or representation to independently confirm its accuracy and completeness.

