

AVAILABLE FOR SALE OR LEASE

2240 NC HWY 24-27 E | MIDLAND, NC 28107



PROPERTY OVERVIEW

AVAILABLE
FOR SALE OR LEASE

The old Bethel Elementary School site consists of approximately 10.5 Acres, with 900 FT of road frontage along Highway 24-27. The site is comprised of 5 buildings (approximately 60,000 SF) built at various times between 1928 and 1958. In addition, the property has 3 ball fields. Great opportunity for adaptive re-use project, or redevelopment, of a well known and important piece of property in Midland, NC.

Located on Highway 24-27 near the intersection with Bethel Church Road in the Town of Midland. The lower end of the property also abuts JM Sossamon Road near the new Bethel Elementary School.

PROPERTY DETAILS

Address	2240 NC Hwy 24-27 E Midland, NC 28107
Available SF	+/- 10.5 Acres Available for Sale or Lease
Zoning	Civic (Note: Midland supports re-zoning)
Frontage	Approx. 900 FT on Hwy 24-27
Parcel ID	55441839940000
Traffic Counts	Monroe Rd. 20,000 VPD
Lease Price	Call for Details
Sale Price	\$399,000
Additional Notes	Utilities present: Electric, Water, Phone, Cable

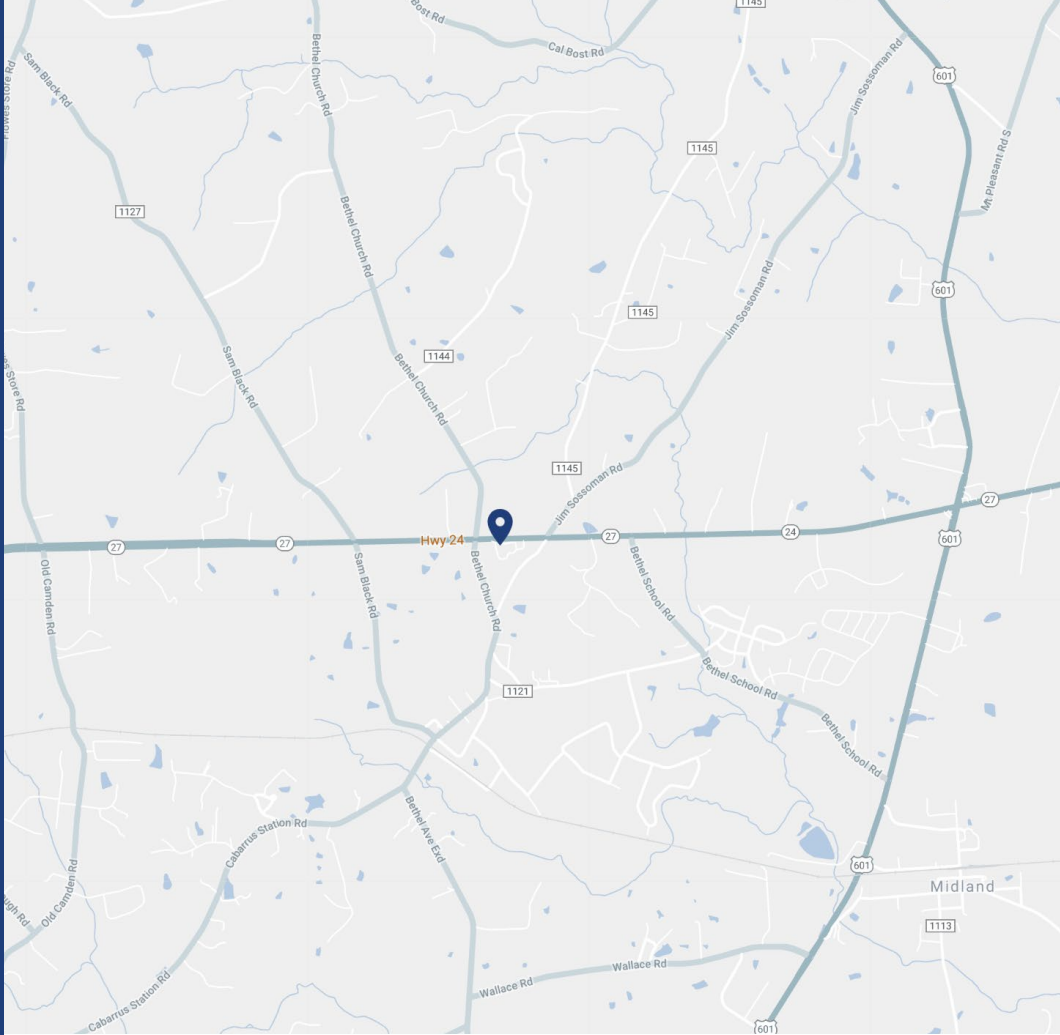

DEMOGRAPHICS

RADIUS	1 MILE	3 MILE	5 MILE
2019 Population	927	6,081	16,314
Avg. Household Income	\$76,236	\$78,181	\$83,446
Median Household Income	\$60,922	\$61,326	\$67,383
Households	380	2,414	6,086
Daytime Employees	151	1,857	3,319

CONCEPTUAL REDEVELOPMENT RENDERING

2240 Hwy 24-27 East

Bethel Church Rd.

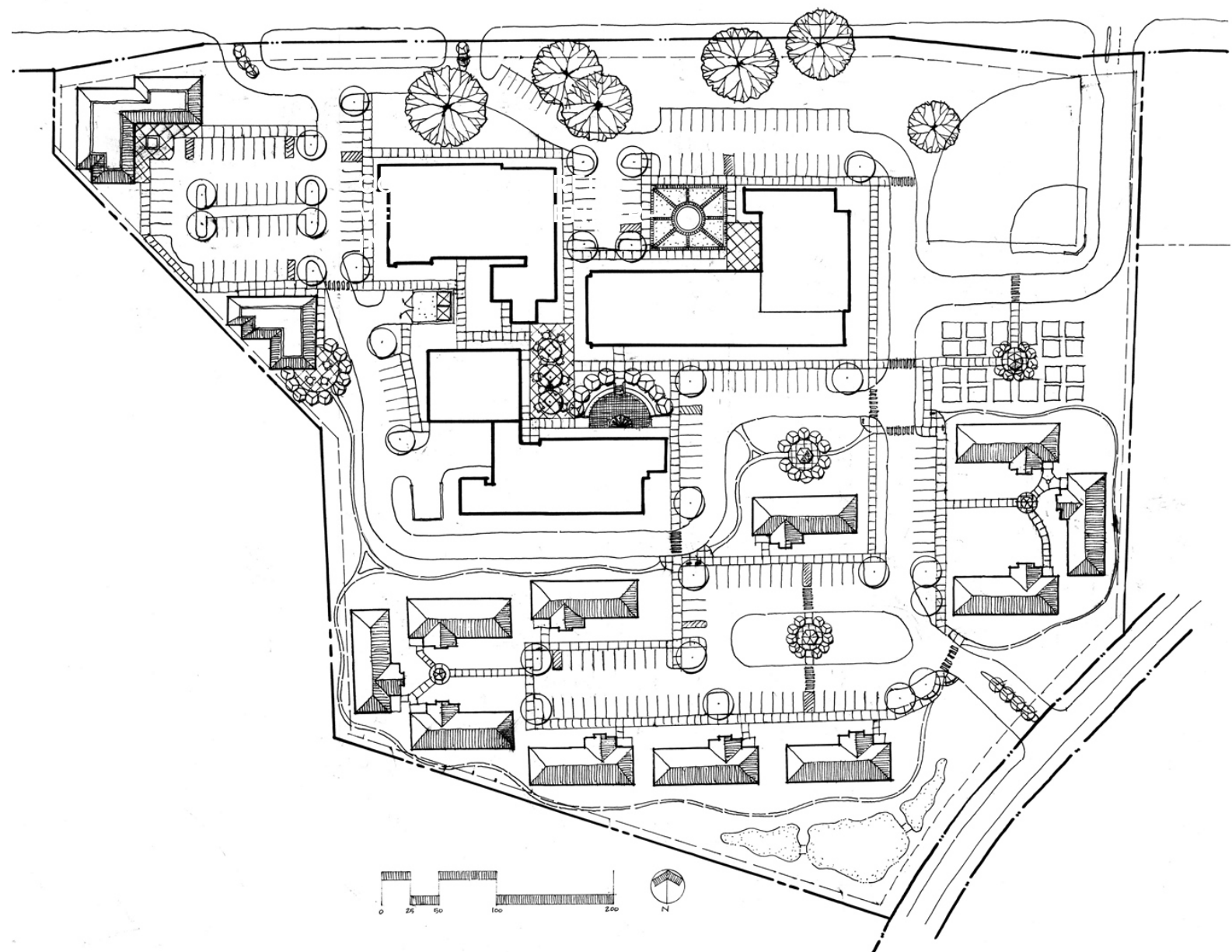

SITE PHOTOS



CONTACT

TRACY EFIRD

tracy@thenicholscompany.com

704.373.9797



THE NICHOLS COMPANY

Website

www.TheNicholsCompany.com

Phone

(O) 704.373.9797

(F) 704.373.9798

Address

1204 Central Avenue, Suite 201
Charlotte, NC 28204

This information has been obtained from sources believed to be reliable. While we do not doubt its accuracy, we have not verified it and make no guarantee, warranty or representation to independently confirm its accuracy and completeness.

