

MINT HILL FESTIVAL

6914 MATTHEWS-MINT HILL ROAD | CHARLOTTE, NC 28227

AVAILABLE OUTPARCEL & RETAIL FOR LEASE



MINT HILL FESTIVAL

PROPERTY DETAILS

Address	6914 Matthews-Mint Hill Road Charlotte, NC 28227
Available SF	+/- 1,500 - 3,877 SF Available for Lease Up to 2,000 SF Expansion Shop Space Available
GLA	+/- 59,047 SF
Available AC	+/- 0.71 AC Outparcel Available
Lease Rate	\$16/SF NNN Retail
Lease Rate	\$25/SF NNN Expansion Shop Space
TICAM	\$3.50/SF
Traffic Counts	Matthews-Mint Hill Rd. 18,000 VPD Lawyers Rd. 9,600 VPD



[CLICK HERE TO VIEW DRONE VIDEO](#)

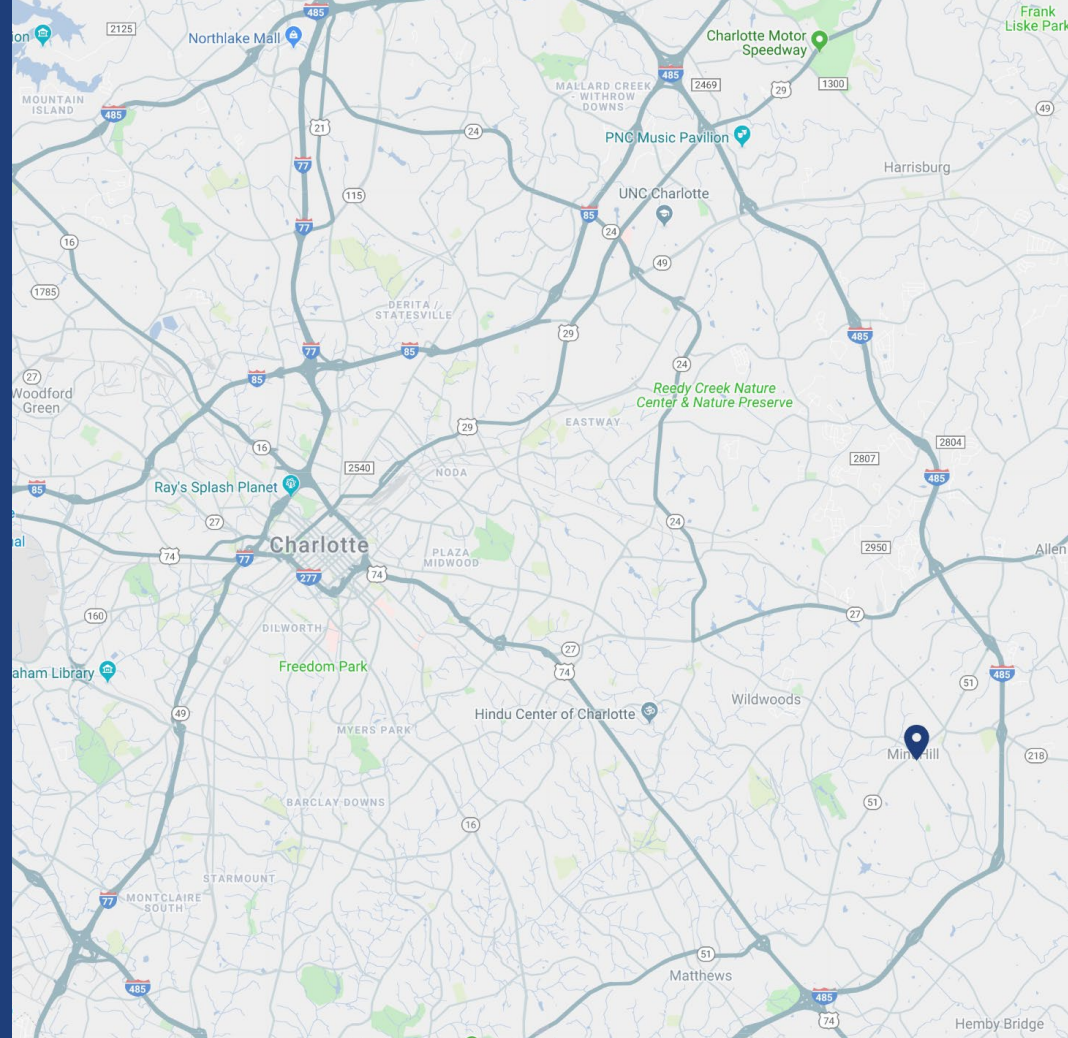

RADIUS	1 MILE	3 MILE	5 MILE
2019 Population	3,146	33,417	118,844
Avg. Household Income	\$115,646	\$100,567	\$81,813
Median Household Income	\$88,284	\$78,590	\$61,777
Households	1,270	12,325	43,442
Daytime Employees	2,091	6,710	31,513

SITE PLAN



TENANT ROSTER		
1	Big Guys Pizza	2,610 SF
2	Gold and Silver Mint	840 SF
3	Cut & Company 2	1,170 SF
4	Superior Insurance	1,080 SF
5	Monroe Hardware	29,577
6	Cut & Company	800 SF
7	Daebak Korean Restaurant	1,500 SF
8	Mint Hill Carpets	1,260
9	Perfectly Polished Nails	1,050 SF
10	Cocktail Cakery	1,052 SF
11	Your Local Game Store	3,340 SF
12	Dollar Tree	8,640 SF
13	AVAILABLE	2,377 SF
14	AVAILABLE	1,500 SF
15	Barks, Bones & Biscuits	2,270 SF
	EXPANSION SPACE	Up to 2,000 SF
OP	AVAILABLE	0.71 AC

FLOOR PLAN

AVAILABLE

Unit 13 - 2,377 SF

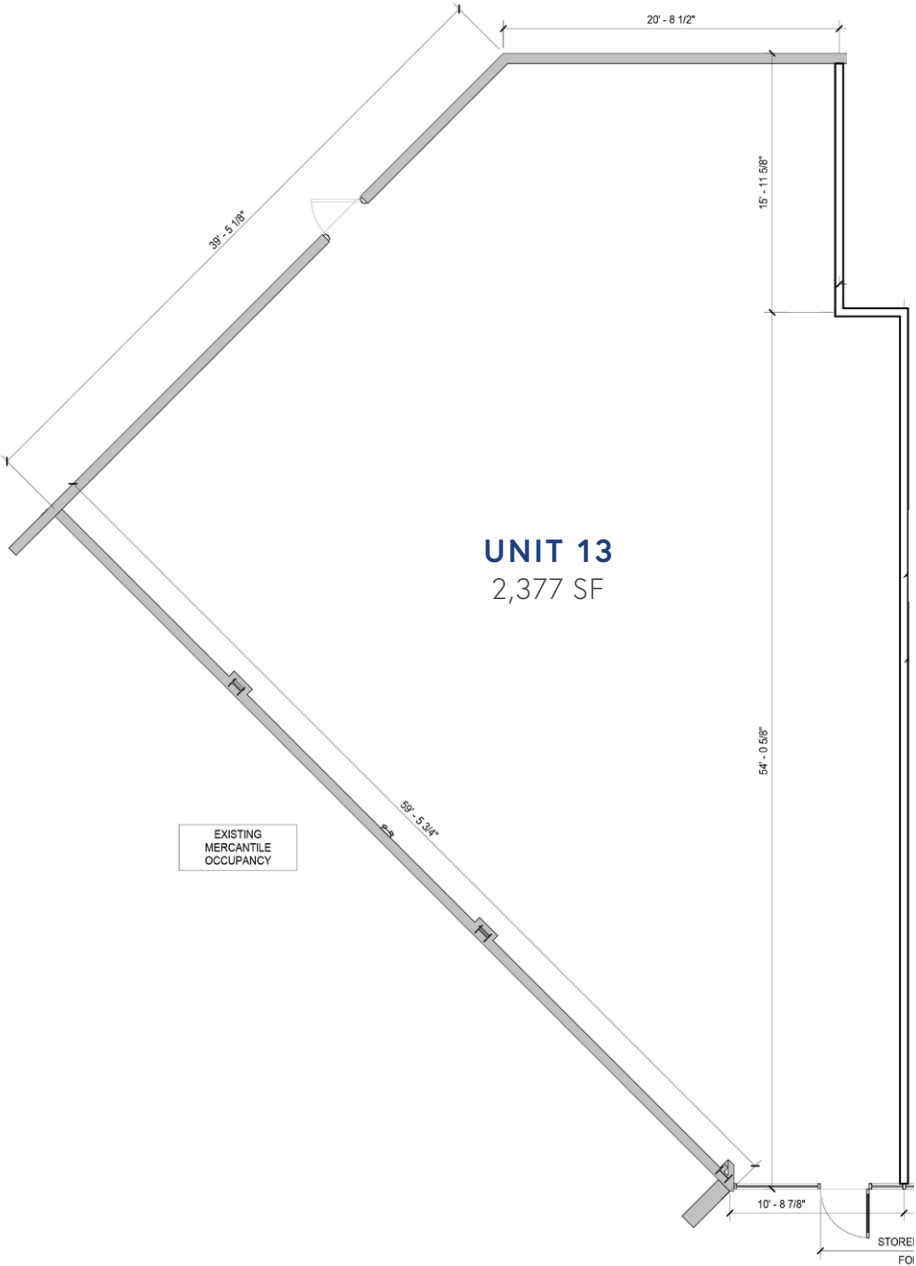

FLOOR PLAN

AVAILABLE

Unit 14 - 1,500 SF

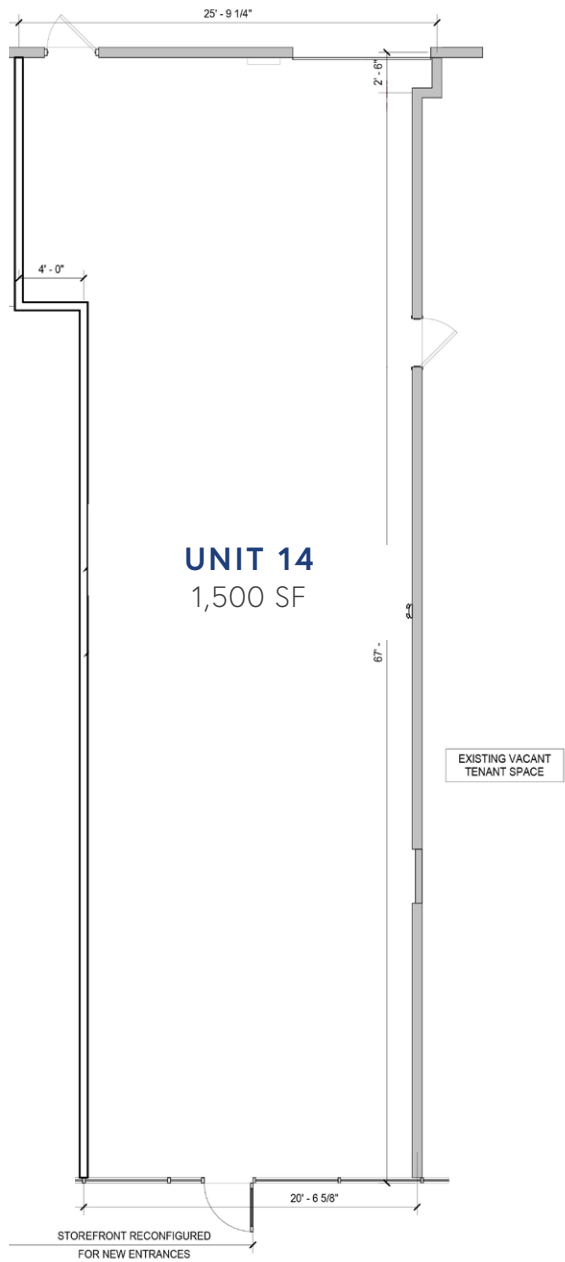

FLOOR PLAN

AVAILABLE

Expansion Shop Space
Up to 2,000 SF

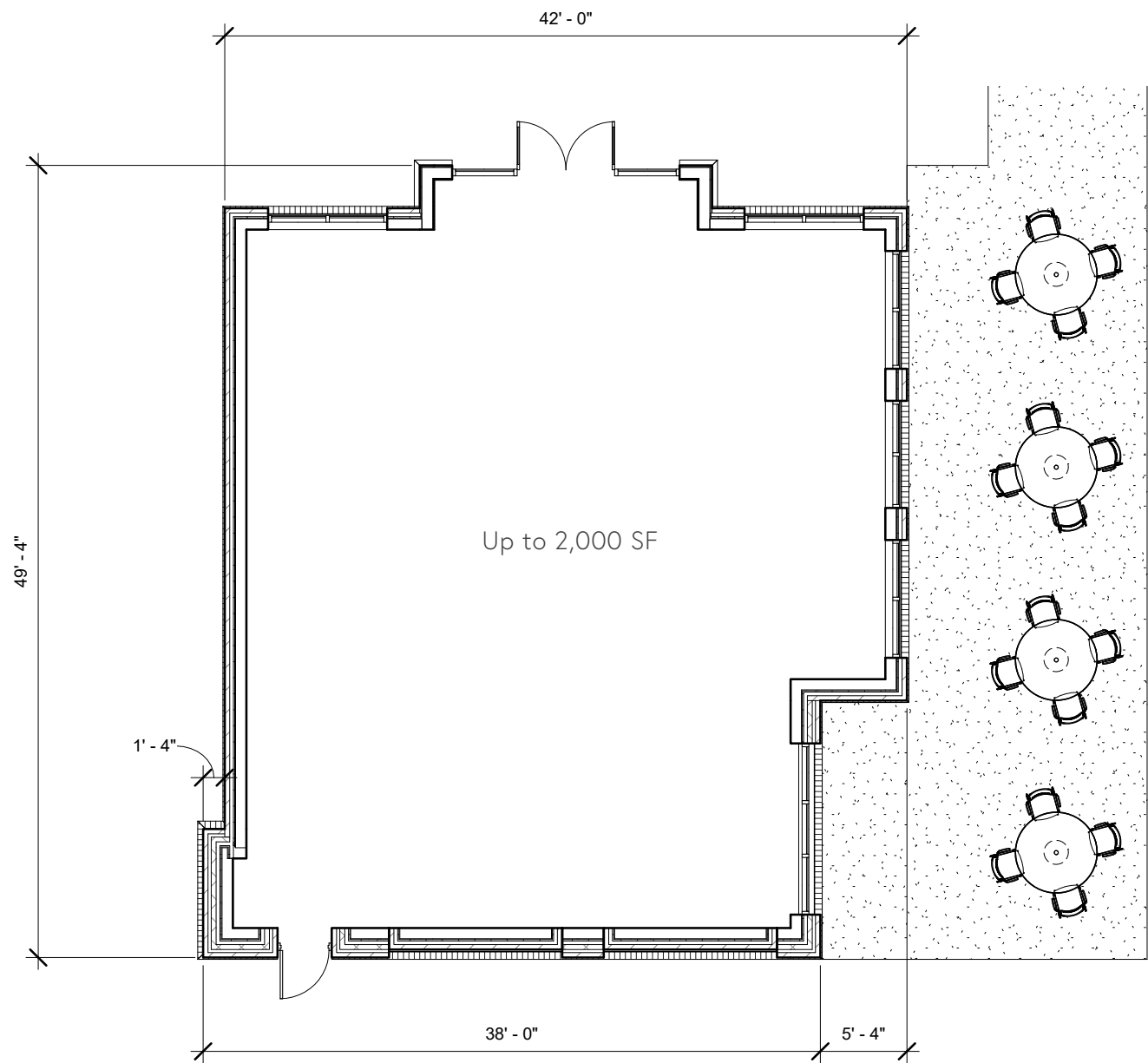

EXPANSION SHOP SPACE | RENDERINGS



MARKET OVERVIEW



CONTACT

JOSH BEAVER

josh@thenicholscompany.com

704.373.9797



THE NICHOLS COMPANY

Website

www.TheNicholsCompany.com

Phone

(O) 704.373.9797

(F) 704.373.9798

Address

1204 Central Avenue, Suite 201

Charlotte, NC 28204

This information has been obtained from sources believed to be reliable. While we do not doubt its accuracy, we have not verified it and make no guarantee, warranty or representation to independently confirm its accuracy and completeness.

